

# plas-aid

The reliable choice in size reduction equipment.

PERFORMANCE

PORTABILITY

RELIABILITY

## SMGL/MGL SERIES

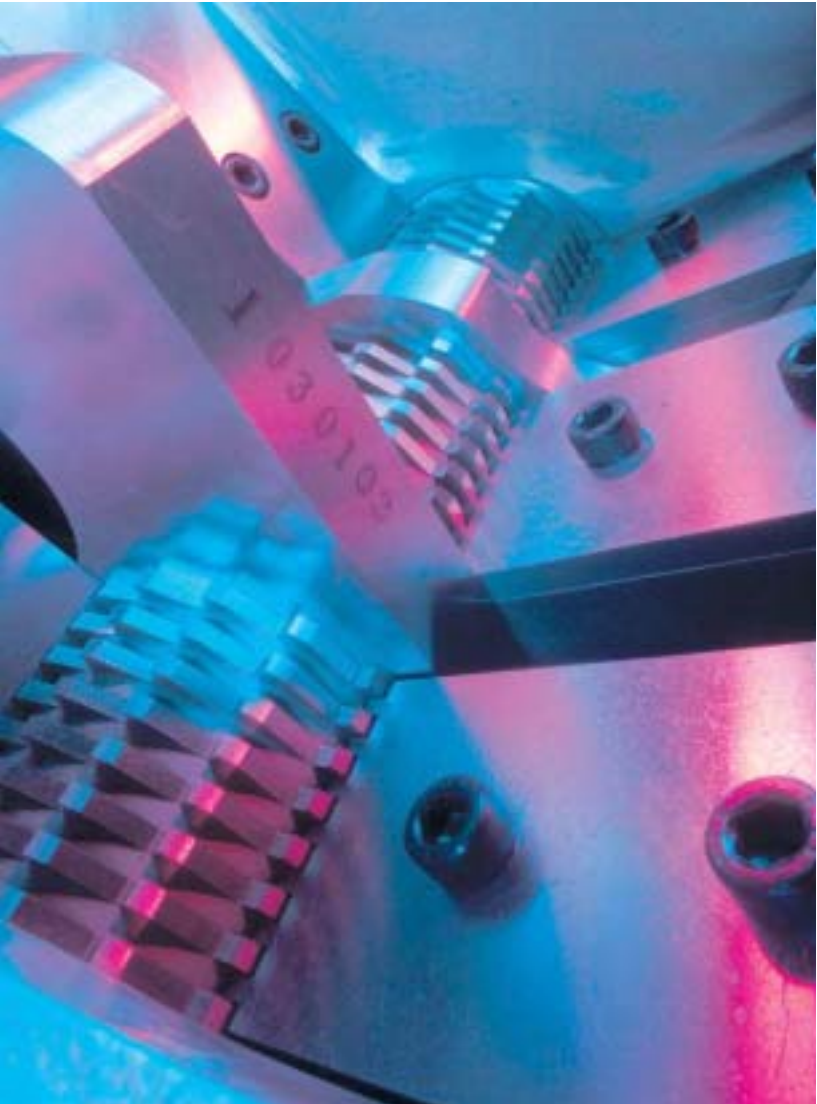

Introducing the **SMGL/MGL**

portable grinders.

Reliable, high performance

in a compact, **portable** design.

Only from Matsui.

## SMGL/MGL SERIES

Take a look at what the new SMGL & MGL offer:

### SMART DESIGN ENHANCES PRODUCTIVITY

The SMGL & MGL pack a lot of smart engineering into little grinders. Combining low-speed, energy-saving, granulating technology with primary and secondary blades, the SMGL & MGL grind to a consistent size. Dusting and cutting errors are reduced, and no "longs" can slip through. This results in regrind that flows more consistently into your production, moving easily through your material handling systems and molding with fewer rejects.

### QUIET, SAFE OPERATION

The SMGL incorporates a steel damper plate to significantly reduce noise, so it operates quietly and efficiently. Units are also equipped with two limit switches and an emergency shut-off button. An integrated thermostat helps prevent the motor from overheating.

### SMALL FOOTPRINT AND PORTABLE DESIGN

The SMGL has a tiny footprint, so it easily glides into place, tucking neatly into a convenient, out of the way place, or snugly up against a machine.

### EASY-TO-CLEAN AND VIRTUALLY MAINTENANCE FREE

Stainless steel components and easy-clean design make changing material and color a snap. And both units are screenless, so there is even less maintenance and no screen to wear out and replace. The smart, simple design means years of reliable, maintenance-free operation.



# Superior grinding technology that enhances productivity.

NOW IN A COMPACT PORTABLE DESIGN.

## SMGL grinder is easy to clean, economical to use

Clean up and resin changes are fast and easy. The SMGL opens wide to expose grinding chamber and blades. And stainless steel parts clean up fast and reduce maintenance costs. Low speed cuts energy costs. Various blade sizes are available to help create re-grind that flows smoothly into production.



## MGL Grinder with the new "wide-open" design.

Say aaaah! The new MGL lets you spread it "wide-open" for fast, easy cleaning, and product and color changes. The unit "unfolds" to completely, and safely, expose every nook and cranny so you can quickly clean and prepare for the next job without worry of contamination.

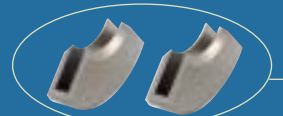

Cutter casings simply lift out for cleaning. No tools needed.

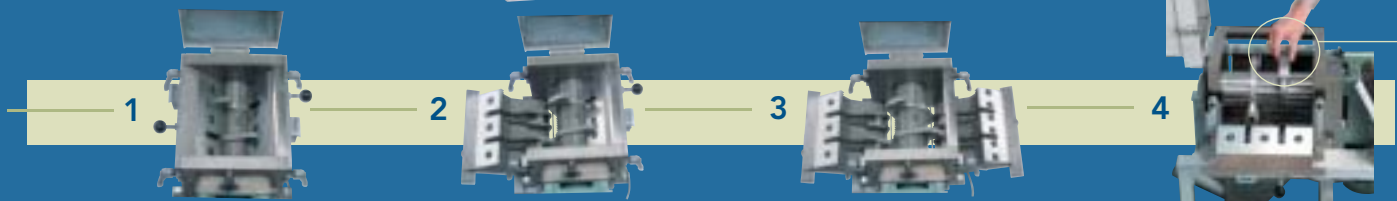

# SMGL/MGL SERIES SPECIFICATIONS

MODEL	SMGL-100U	SMGL-200U	SMGL-300U	MGL-100U
POWER (VOLTS)	230 or 460			
MOTOR CAPACITY (HP)	1.0	2.0	3.0	1.0
ROTATING SPEED (RPM)	22.5			
ROTATING CUTTERS	3			
CRUSHING CUTTERS	2			
BED CUTTERS	3			
GUIDE PLATES	3			
SIZE OF RUNNER CHUTE (INCHES)	10 x 9	10.5 x 13.5	18.5 x 15.5	10 x 9
EFFECTIVE CUTTING CHAMBER DIM (INCHES)	10.5 x 10	13.5 x 11.5	16 x 16	10.5 x 10
MACHINE DIMENSIONS (INCHES)	29 x 18 x 52.5	32.5 x 23.5 x 60	49.5 x 23.5 x 63.5	29 x 18 x 52.5
CUTTER SIZE (MM)	4 x 5	5 x 5	6 x 7	4 x 5
WEIGHT (LBS)	396	606	992	396
BREAKER CAPACITY (AMPS)	20			
KKB SUCTION HOPPER (FT <sup>3</sup> )	.14	.32	.35	.14
OPTIONS:				
SKB SUCTION HOPPER (FT <sup>3</sup> )	.14	.32	.35	.14
COLLECTION TANK	.70	1.70	1.97	.70
LEVEL SENSOR	HL-400			
SIGNAL LIGHT	ET-200-1			

**CHICAGO HEADQUARTERS**

1250 West Lunt Avenue | Elk Grove Village, IL 60007 | T 847-290-9680 | F 847-290-9685

**LOS ANGELES OFFICE**

1240 North Lakeview, Suite 180 | Anaheim, CA 92807 | T 714-693-1101 | F 714-693-1345